

Installation Instruction

Overview of filter package:

In the filter package, we provide multiple options of installation. Below is the overview of components included in this package.



PART NO	QT	DISCRIPTION	PART NO	QT	DISCRIPTION	PART NO	QT	DISCRIPTION
1	1	Filter assembly	5	1	Filter housing wrench	9	2	Sheet metal tapping screw
2	1	Clear water tube	6	2	Clamp	10	2	Nylon lock nut
3	1	Barb hose fitting	7	2	Machine screw	11	2	Flat washer
4	1	Male garden hose fitting	8	2	Steel anchor			

Step 1: Connect filter assembly to output fittings:

- Barb hose fitting. Apply barb fitting to the “out” outlet. Attach the tube to the barb fitting with hose clamp;
- Male garden hose fitting: Apply garden hose fitting sub assembly to the “out” outlet. Garden hose is not provided in this package.



Step 2: Filter installation locations:

- Install filter on the side bar of pump with machine screws and nuts.

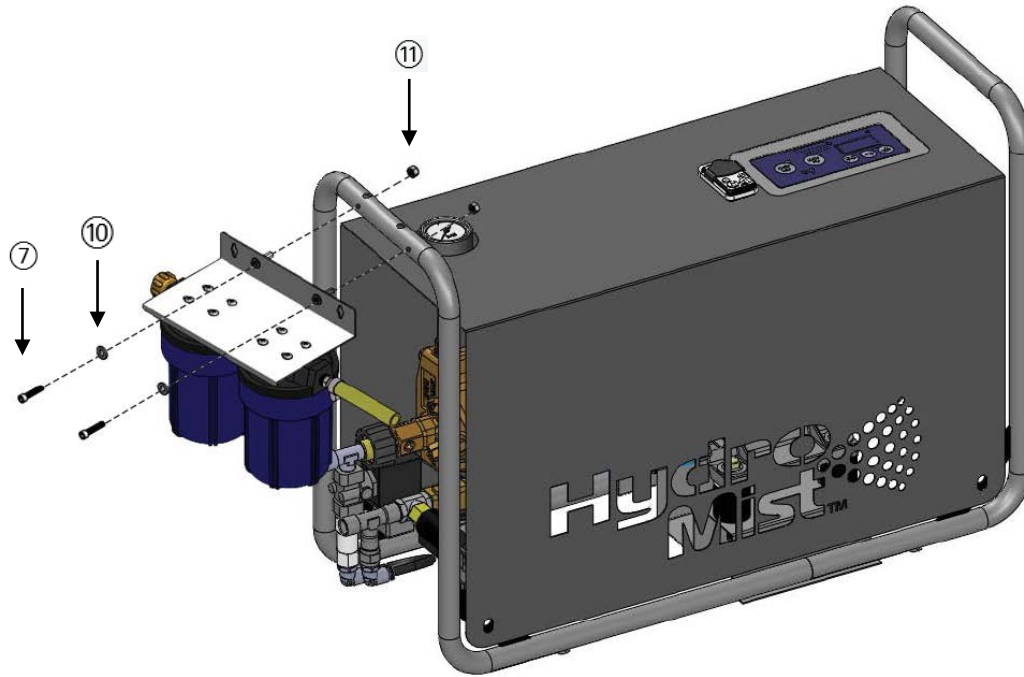

- Install filter on concrete/wood wall. In the package, we provided 2 steel anchors and 2 metal sheet tapping screws. If installed on wood surface, use only screws. If installed on concrete wall, apply anchors and screws together.

